

Denali 2



Woody Valley

Manual Edition 0.0 - 04.2025





Woody Valley

Congratulations on purchasing a WOODY VALLEY product. We remind you that all our products are the result of meticulous research in constant collaboration with pilots from all over the world. This is why your opinion is so important. Your experience and collaboration allows us to constantly improve our harnesses, to always get the best out of every Woody Valley creation

MANUFACTURER'S INFORMATION:

WOODY VALLEY srl
via Linz, 23 - 38121 Trento - ITALY
Phone +39 0461 950811
Website: www.woodyvalley.eu
E-mail: info@woodyvalley.com

HARNESS LABELS
INFORMATION

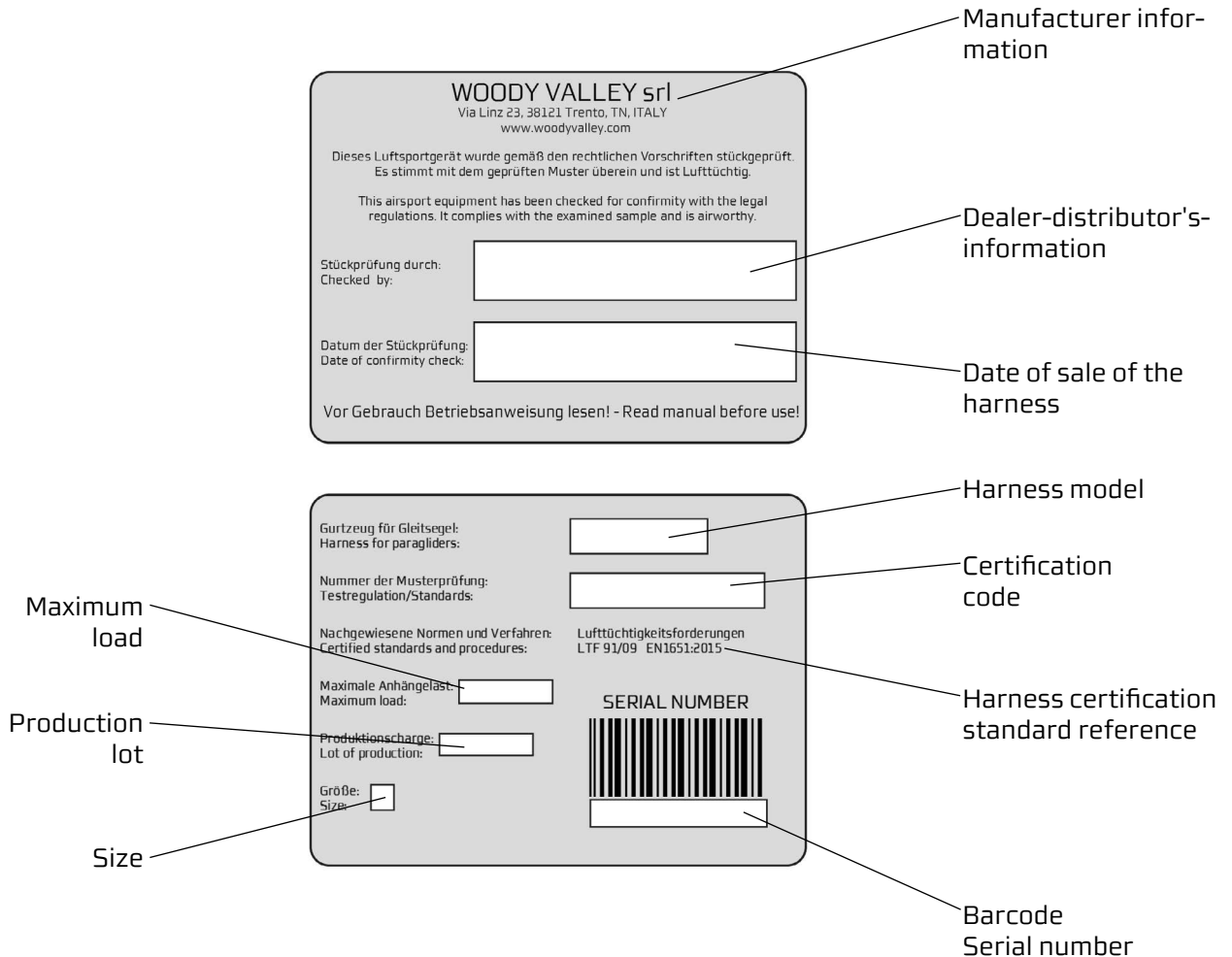

THANK YOU

Thank you for choosing a Woody Valley product, we invite you to carefully read this important tool which is the harness user manual

We are confident that this harness will be able to provide you with greater comfort, control, performance and enjoyment in flight. We know very well that reading a user manual may not be exciting. In this case, please bear in mind that the product in question is not a citrus squeezer or a mobile phone and that the correct use of the harness helps greatly in reducing the risk of flight accidents. This manual contains all the information needed to assemble, adjust, fly and maintain your harness. An accurate knowledge of your equipment will improve your personal confidence and allow you to increase your potential.

The Woody Valley Team

SAFETY NOTE

By purchasing Woody Valley equipment, you acknowledge that you are a licensed paraglider pilot and you accept all risks inherent in paragliding including injury and death. The improper or incorrect use of such equipment considerably increases this risk. In no event shall Woody Valley and your Woody Valley equipment dealer be liable for personal injury, yourself or a third party, or damage of any kind. If any aspect of the use of our equipment is not clear enough, we recommend that you contact your local reseller or Woody Valley directly.

INDEX

1- GENERAL INFORMATION

- 1.1 - Concept
- 1.2 - Protection and safety
- 1.3 -Handle with Care

2 - BEFORE USE

- 2.1 - Reserve parachute
 - 2.1.1 - Handle
 - 2.1.2 - Inserting the reserve parachute
 - 2.1.3 - Connecting the reserve parachute to the harness
 - 2.1.4 - FRONT LIGHT RESCUE CONTAINER ANTHRACITE adjustment
 - 2.1.5 - Extracting the reserve parachute
- 2.2 - Harness adjustments
 - 2.2.1 - Adjustment of the shoulder straps
 - 2.2.2 - Back adjustment

3 - FLYING WITH DENALI 2

- 3.1 - Pre-flight checks
- 3.2 - Putting on the DENALI 2
- 3.3 - Flying tandem
- 3.4 - Flying over water
- 3.5 - Winch launch bridle attachment
- 3.6 - Landing with DENALI 2
- 3.7 - Disposal of the harness
- 3.8 - Rules of conduct in natural environments
- 3.9- Hooking up the wing

4 - FOLDING THE HARNESS

5- CHARACTERISTICS AND INSTALLATION OF ACCESSORIES

- 5.1 - Speed-bar assembly
- 5.2 - DENALI AIRBAG assembly

6 - MAINTENANCE AND REPAIR

7 - WARRANTY

8 - HOMOLOGATION CERTIFICATES

9 - TECHNICAL DATA

1- GENERAL INFORMATION

This manual is an integral part of the DENALI 2 harness and must be kept carefully for future consultation.

If you would like further information, contact your dealer or Woody Valley directly.

Before using the harness, the pilot is advised to read this manual carefully.

Declaration of Conformity

The manufacturer WOODY VALLEY srl hereby declares that its products comply with the UNI EN 1651 - NfL 2024-2-785 standards

This equipment must contain:

- Harness
- Snap-hooks
- Containment bag

The main options available are:

- Two step light Speed-bar
- Backpacks of various volumes
- Ventral reserve container
- Removable Airbag protection

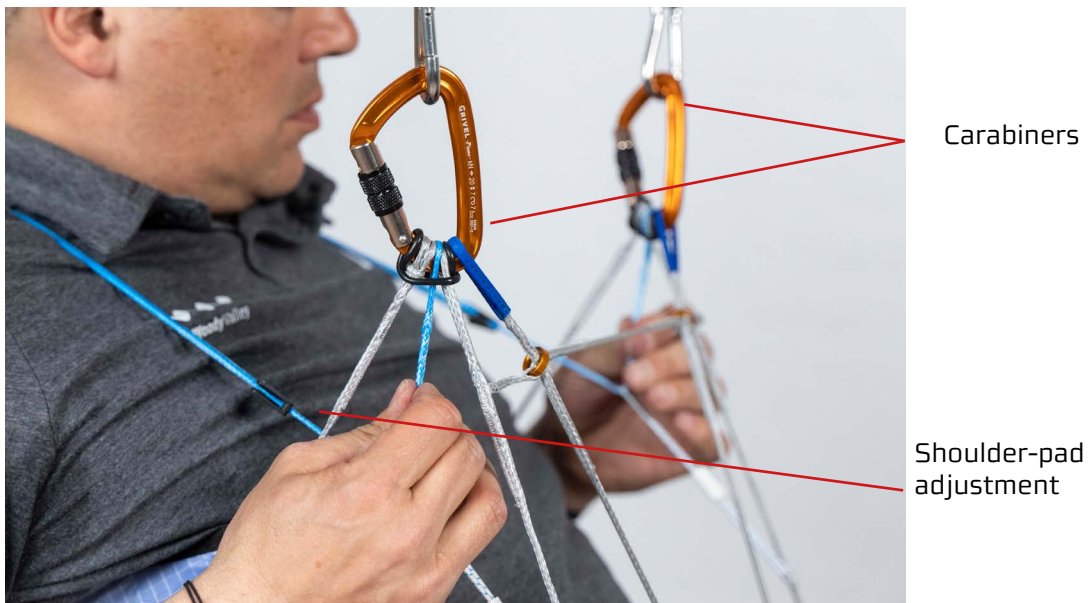

1.1- Concept

DENALI 2 is an extremely lightweight harness (weighing only 300 grams M) designed for paragliding and certified for a maximum weight of 120 kg. An Hike & Fly harness designed for those who prioritize lightweight and reduced volume without compromising on performance. Quick and intuitive to put on, without the need to adjust buckles and straps. Simple and smooth to fly.

1.2 - Protection and security

DENALI 2 does not include any standard protection. There is the DENALI AIRBAG as optional, that you can fix on the harness.

1.3 - Handle with care

The choice of light materials and the design make the DENALI 2 subject to damage caused by improper use. The life of this product depends to a large extent on how carefully you use it. A light product is much more sensitive to mechanical stress of all kinds.

It is not recommended to perform acrobatic or extreme maneuvers (SIV included).

Intense stress can cause damage to the harness UNRELATED to safety and not covered by warranty.

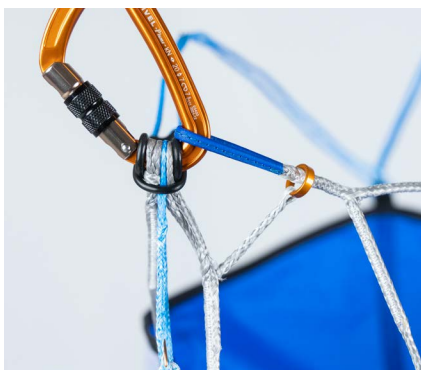

2- BEFORE USE

2.1- Reserve parachute

The ventral reserve parachute container FRONT LIGHT RESCUE CONTAINER ANTHRACITE is not included in the purchase of the DENALI 2 harness, but is an option and must be positioned in front of the chest strap adjustment.

It must be fixed with the bridle on both main carabiners and secured with the strap on the connection between the right and left support. The container is suitable for small to medium parachutes with a maximum volume of 5.6 litres.

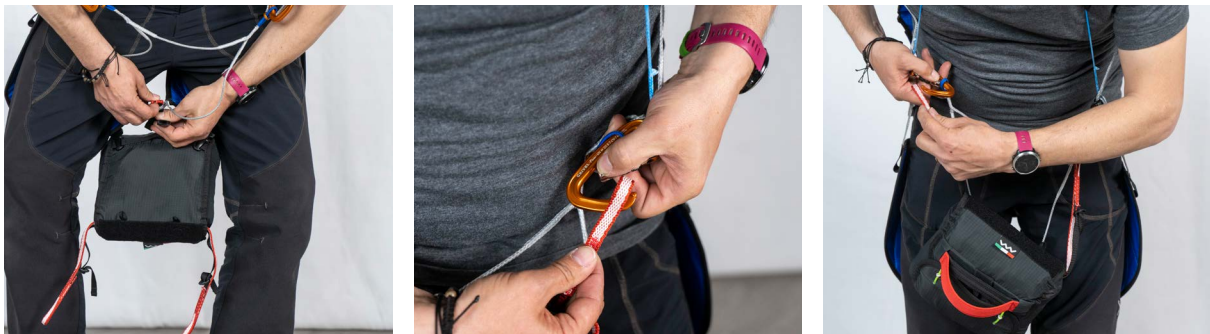

2.1.1- Handle

The optional FRONT LIGHT RESCUE CONTAINER ANTHRACITE is supplied with extraction handle and bridle. Do not use other handles adapted for this purpose.

To connect the handle to your emergency, simply thread the loop located at the end of the handle into the corresponding loop in the emergency container. Then pass the entire handle through its own loop, creating a "wolf's mouth" knot.

ATTENTION

Check that the length of the link between the handle and the container does not interfere with the reserve parachute lines.



2.1.2- Inserting the reserve parachute

Connect the bridle of the reserve parachute to the bridle line loop of the ventral reserve parachute container FRONT LIGHT RESCUE CONTAINER ANTHRACITE, through the two loops. Subsequently, the reserve parachute must be passed through the large eyelet of the bridle of the parachute itself. By doing so, you achieve a connection that should be tightened as much as possible to avoid dangerous friction between the two cords during the reserve opening shock.



The bridle of the container has a Velcro designed to be fastened with the container. Once the bridle is connected, insert the parachute and its bundle into the container while keeping the handle facing upward. To close the flaps of the container, you can use a thin cord (such as a paragliding line) and insert it through each elastic loop. With the help of this cord, you will be able to close the container securely.



Insert the elastic loops through the eyelets of the upper flap and then into the lower one, proceed by fixing the pins of the handle in the respective elastic loops at the end remove the thin cord. Secure the handle to the container with the velcro, so that it maintains the ideal position and avoids accidental opening, and lastly insert the two pins into the holes in the lower flap.

**ATTENTION:**

Each new combination of reserve parachute and harness that will be mounted for the first time must be checked by an official harness or reserve dealer, verifying its effective extractability, if not by a flight instructor. The verification must be carried out hanging from a flight simulator, the reserve parachute extraction must be perfectly possible in the normal flight position.

The paragliding harness and reserve parachute deployment system is not suitable for use in free fall and strong shocks.

Its supporting structure is designed, tested and approved to withstand the opening shock of the reserve parachute, according to the standards required for paragliding.

This does not exclude that the other parts of the harness may suffer damage due to the opening shock of the reserve parachute.

Whether this happens out of necessity in the event of a real accident, or voluntarily, for example during a safety course.

2.1.3- Connecting the reserve parachute to the harness

The ventral emergency container FRONT LIGHT RESCUE CONTAINER ANTHRACITE is connected to the harness via the eyelets of the bridle which are inserted into the main carabiners. Then connect the fastening strap.



ATTENTION:

The bridle is attached to both carabiners.

2.1.4 - FRONT LIGHT RESCUE CONTAINER ANTHRACITE adjustment

To adjust the position of the FRONT LIGHT RESCUE CONTAINER ANTHRACITE container, we recommend hanging it from a simulator, properly tightening the fastening straps.

The buckles in the loops of the attachment bridle are used for adjustment. It is advisable to make adjustments symmetrically for optimal positioning. Make sure that the tools do not scrape against the chest strap.



2.1.5- Deploying the reserve parachute

It is important to periodically research the position of the launch handle during normal flight, so that the reaction movement to grab it is instinctive in case of emergency.

In the event of an emergency situation, the launch procedure is as follows:

- Look for the pull handle and grip it firmly with one hand.
- Pull the handle outwards to extract the reserve parachute from the harness container.
- Look for a free space, and in one single movement, launch the reserve parachute away from you and the glider.
- After deployment to prevent the paraglider from interfering with the reserve parachute:
 - if the leading edge is up, grab the D-risers or the brakes and bring your glider down;
 - while if the glider has the leading edge down pull a riser "D" or a brake until the glider rotates with the leading edge up and then subsequently pull both brakes or risers to gybe your paraglider more easily.
- Stand upright when landing and be sure to use a "parachute technique" to reduce the risk of injury.

After each parachute deployment, the harness must be inspected by qualified personnel.



2.2- Harness adjustments

DENALI 2 provides the option to adjust the shoulder strap cord and, if needed, it is possible to lengthen or shorten the back strap.

The harness has been designed and manufactured according to an ergonomic standard which, in its extreme simplicity, allows it to be comfortable for most pilots.

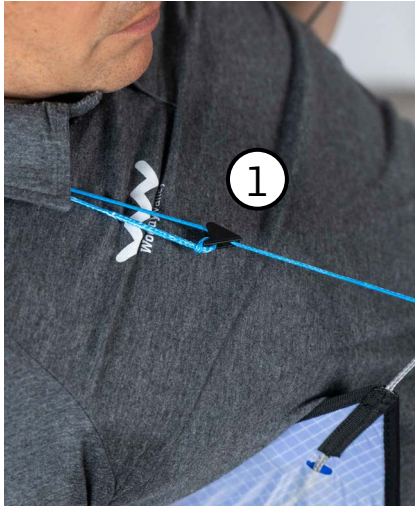

Shoulder strap adjustment
Paragraph 2.2.1 **1**

Back adjustment
Paragraph 2.2.2 **2**

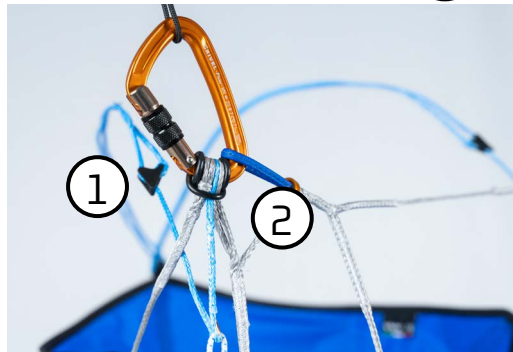

2.2.1- Adjustment of the shoulder straps

The adjustment of the shoulder strap compensates for the pilot's height variation. We recommend adjusting the shoulder straps so that they adhere to your shoulders without being too loose or too tight.

To adjust the strap, use the gray line lock located at the front. To release it, simply open the strap cords, which will unlock the system and allow you to adjust the length of the strap.

To secure the shoulder straps, push the line lock until the cord of the strap becomes taut.

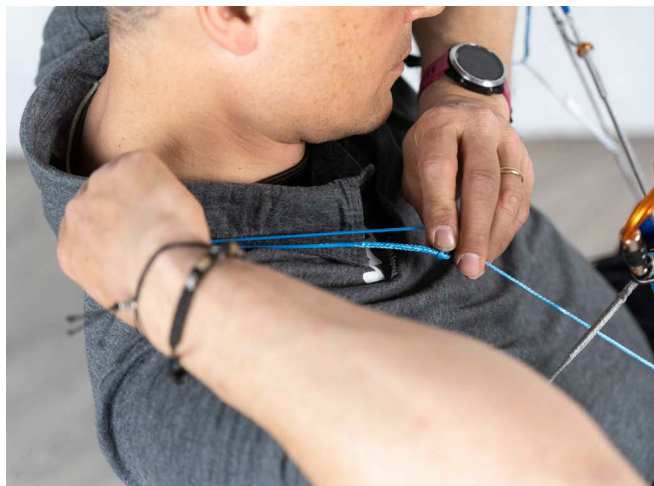
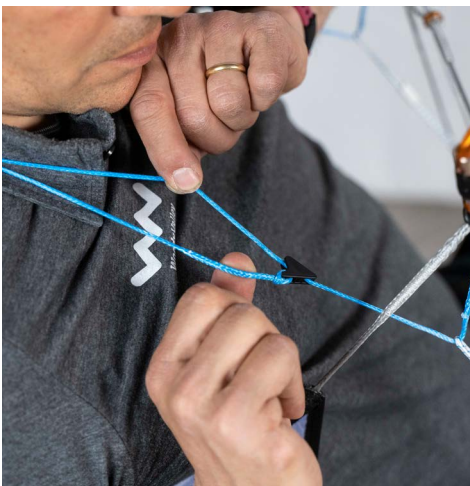

ATTENTION:

The adjustment must be performed symmetrically on both sides.

2.2.2 - Adjustment of the back

If the flying position feels uncomfortable due to being too "seated," it is possible to lengthen the back cord by releasing the loop from the carabiner. This adjustment allows for a more upright position, providing increased comfort during flight. Similarly, it is possible to create additional loops to shorten the back cord. To perform this operation, you need to release the O-ring that holds the bridle locked in the carabiner.

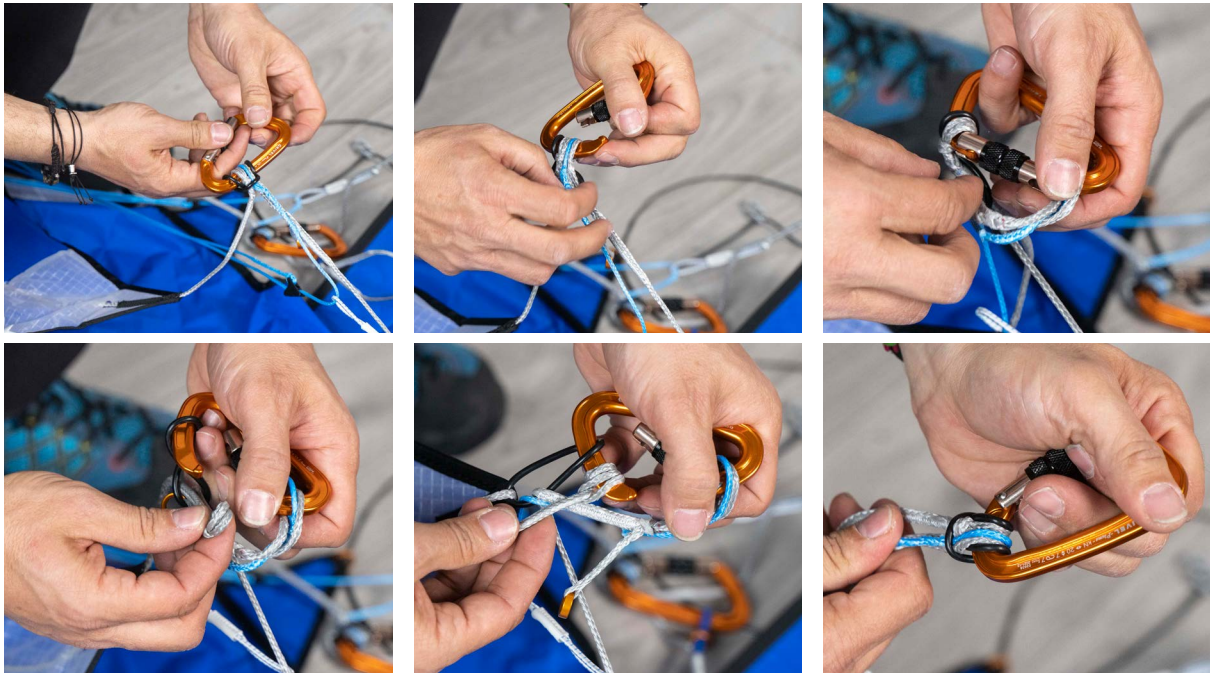

3- FLYING WITH DENALI 2

3.1- Pre-flight checks

For maximum safety, use a good and thorough pre-flight check method and repeat the same mental sequences before every flight.

Check that:

- The reserve parachute handle is correctly locked in position and the pins are firmly engaged.
- Make sure that the paraglider is properly attached to the harness using the main carabiners, which must be securely closed using their respective locking mechanisms.
- The speed-bar is correctly mounted on the glider.

After careful assessment that the weather conditions are favorable for flying, put on the harness.

3.2 - Putting on the DENALI 2

Based on individual needs, DENALI 2 can be worn like any other harness with the "get up" system. Place your arms through the shoulder straps and pass the loop of the leg strap (the blue line one) inside the small ring located below the carabiner, and then insert it into the carabiner itself. This way, you can close the harness securely.

Alternatively, if you prefer to keep the harness closed with the leg strap loops already inserted into the carabiners, simply thread your legs between the leg strap cords and your arms through the shoulder strap cords. This operation, despite its simplicity, must be carried out and carefully checked for a flight in total safety.



ATTENTION:

It could happen that when you put on the DENALI 2, the carabiners may inadvertently rotate within the shoulder strap cords and the main cord, causing them to twist or tangle. In the same way, the leg straps, only if they are kept open, could make turns on themselves. So check carefully before taking off that the lines are well stretched out and not twisted.

Ensure that the chest strap is ALWAYS within the ring.

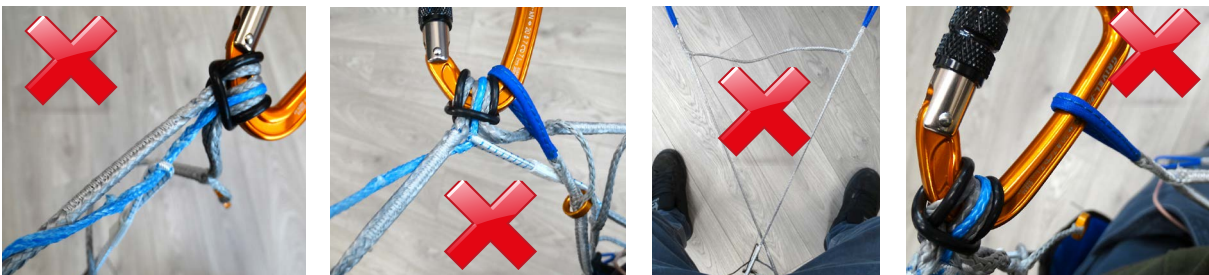



3.3- Flying in tandem

DENALI 2 can be used for tandem flight for the passenger.

3.4- Flying over water

DENALI 2 has no particular contraindications in flying over water, but we remind you that landing in water is still dangerous. Woody Valley recommends the use of an appropriate life jacket when flying over water.

3.5- Towing hook

DENALI 2 is not suitable for tow launch.

3.6- Landing with DENALI 2

Before landing, slide your legs out of the harness so that you adopt an upright position. It is not recommended to land in a seated position because besides being very dangerous for the back, there is no protection in the DENALI 2. Standing up before landing is a much more effective active safety system.

3.7- Disposal of the harness

The materials used in a paraglider require proper disposal. It is recommended to return the equipment at the end of its life. The harnesses will then be properly disposed of by us.

3.8- Rules of behavior in natural environments

It is recommended to respect nature and the landscapes that surround us when we practice our sport. Do not leave the marked trails, do not litter, avoid making excessive noise, and respect the delicate balance that exists among the mountains.

3.9- Hooking up the wing

To attach the wing, insert the wing risers into the harness carabiners in the correct flying position.

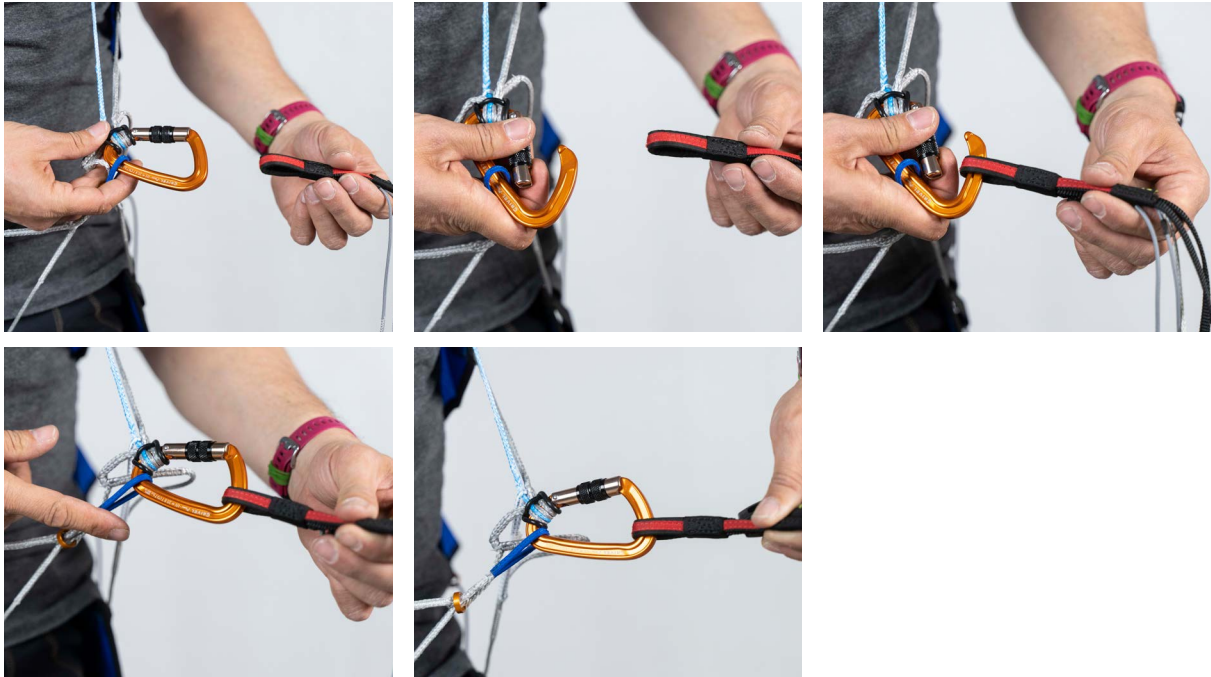

4- FOLDING THE HARNESS

To fold DENALI 2 just close it in a sandwich, joining the leg supports and folding the back on itself keeping all the lines inside



5- CHARACTERISTICS AND INSTALLATION OF ACCESSORIES

5.1 - Speed-system assembly

To assemble the speed system in the DENALI 2, simply pass the speed lines through the belt loop located on the outside of the pilot's legs and then into the side ring.

For proper adjustment, you need to hang on a simulator, attach yourself to the paraglider's risers, and have a friend assist you by holding the risers while adjusting the length of the speed-system lines. The bar should be at a distance no greater than 10 cm below the front part of the harness. Adjusting the line too short could lead to having the speed-system constantly pulled and unintentionally engaged during flight. It is safer to take off with the speed-bar slightly longer and gradually shorten it in subsequent flights. Remember that each adjustment must be performed symmetrically on both sides.

Before taking off, insert one foot into the elastic located at the end of the speed-bar, tightening it around the ankle with the corresponding attachment.

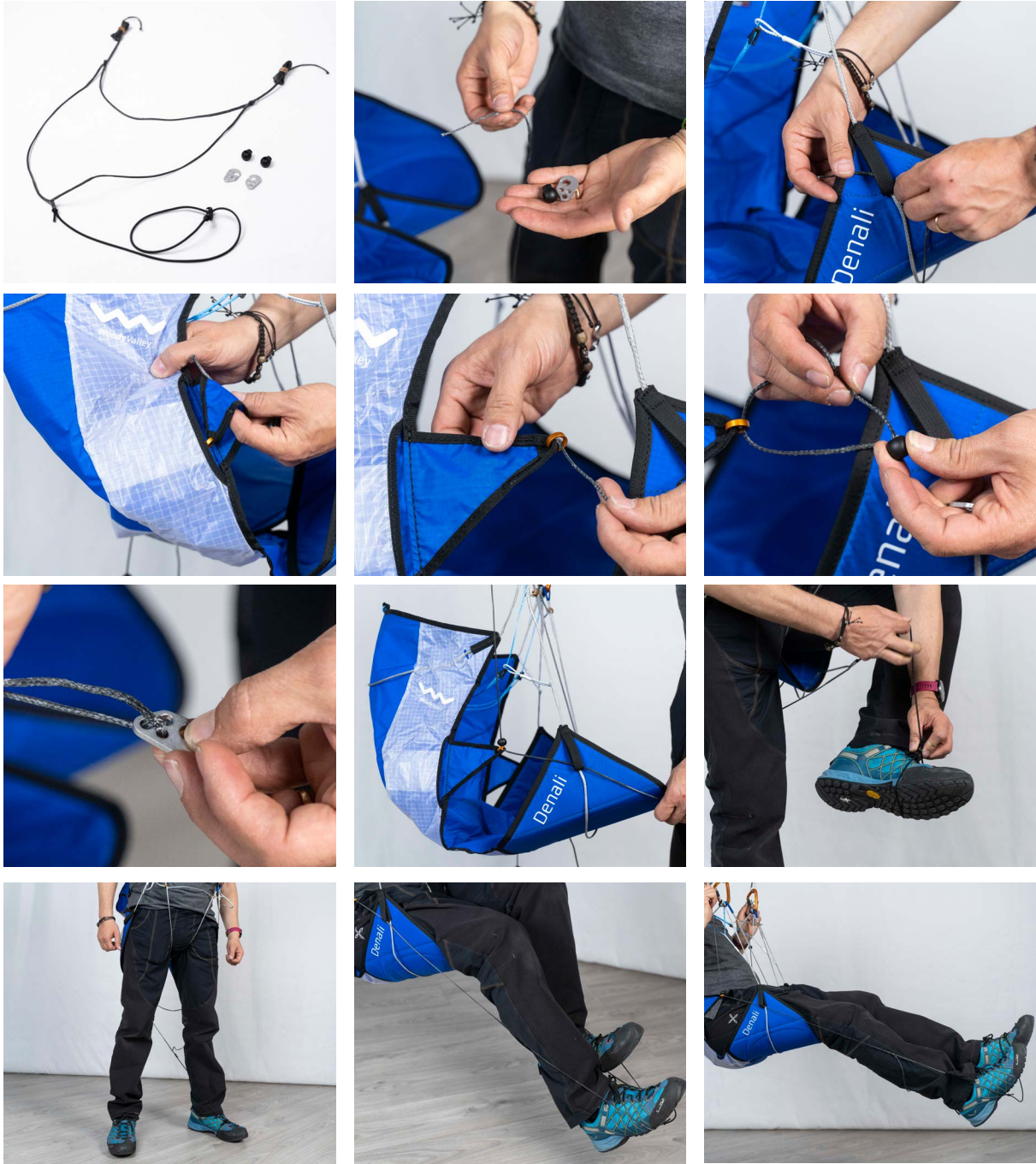

If the accelerator is not used, it is advisable to close the side flaps with the ring in the appropriate pockets.

5.2 - DENALI AIRBAG assembly

DENALI 2 have the possibility to mount an AIRBAG dedicated. You can find six small loops made by straps on the back and under the legs of your DENALI 2.

To connect the airbag insert each loop on the small hole on the fabric over the toogles than close it with the toggle as show on the pictures below. Please be carefull to connect correctly all the six fixing points.



Thanks to the use of Nitinol (highly resistant and super elastic metallic wire) inserted in the lower edge of the airbag, we were in any case able to obtain 60% of the protective capacity before complete inflation which takes place in flight. The inflation valve has also been completely redesigned to guarantee airflow in the airbag notwithstanding the position of the legs. The new valve improves the performance and aesthetics of the airbag.

6- MAINTENANCE AND REPAIR

Check the harness after any impact, bad landing or takeoff, or if there is any sign of damage or excessive wear.

However, we recommend having the harness checked every two years by your dealer and replacing the main carabiners every five years.

To avoid premature aging of the harness, avoid sliding the material on the ground, stones or abrasive surfaces. Avoid unnecessary exposure to UV rays (sunlight) beyond what is required for normal flying activities. Whenever possible, avoid exposure to moisture and heat.

Store all your flight equipment in a dry and cool place; never store it when it is still damp or wet.

Keep your harness as clean as possible by regularly cleaning off dirt with a plastic bristle brush and/or damp cloth. If the harness gets particularly dirty, wash it with water and mild soap. Allow the harness to dry naturally, in a well-ventilated place away from direct sunlight.

Repairs and replacements of harness parts should not be carried out by the user. Only the manufacturer or authorized individuals can utilize materials and techniques that ensure the functionality of the product and compliance with certification standards.

For any maintenance request, from an authorized dealer or Woody Valley, please communicate the complete identification number, shown on the silver label.

We recommend paying utmost attention to the way the harness is used and stored. Proper usage will prolong the life of the harness.

We wish you great flights and happy landings with DENALI 2!



7- GUARANTEE

The legally mandated 2-year warranty period commits us to rectify any manufacturing defects in our products that can be attributed to manufacturing flaws.

We recommend validating the warranty period by completing the form available on our website under the "Support" section within 10 days of the purchase date. Please enter the identification code of the harness, which can be found on the silver label located in the rear pocket.

To initiate a warranty claim, it is necessary to promptly inform WOODY VALLEY upon discovering the alleged manufacturing defect. Please send the identification code of the harness along with a detailed description of the issue encountered.

Subsequently, to restore the defective product, it will be necessary to send it to WOODY VALLEY or authorized entities designated by them.

WOODY VALLEY reserves the right to decide the best method for restoring the harness (repair, replacement of parts, or the entire product).

The warranty does not cover damages resulting from careless or improper use of the product (such as inadequate maintenance, improper storage, overloading, exposure to extreme temperatures, etc.). The same applies to damage attributable to accidents, emergency parachute opening shocks, and normal wear and tear.

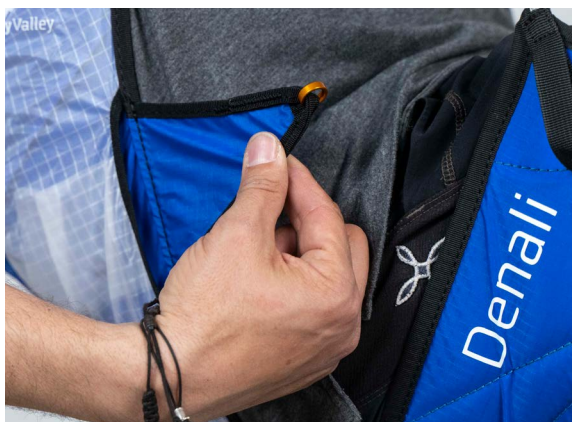

8- APPROVAL CERTIFICATES

AIR TURQUOISE SA | PARA-TEST.COM

Route du Frê-au-Comte 8 • CH-1804 Villeneuve • t: +41 (0)21 965 65 65

Test laboratory for paragliders, paraglider/harnesses and paraglider reserve parachutes



Harness inspection certificate - EN

Inspection certificate number: PH_378.2022 Impact pad number: n/a

Manufacturer data		
Manufacturer name:	Woody Valley srl	
Representative:	Simone Caldana	
Street:	Via Linz 23	
Post code / place:	38121 Trento	
Country:	Italy	

Sample data:		Harness	Impact pad
Name:	DENALI	Name Impact pad: ⁽¹⁾	n/a
Type:	ABS	Impact pad integrated: ⁽¹⁾	n/a
Size:	M	Impact pad type:	n/a
Weight of Sample [kg]:	0.26	Weight of Sample [kg]: ⁽¹⁾	n/a
Serial number:	111 0115 001P	Serial number ⁽¹⁾	n/a
Clip-in weight [kg]:	120	Date of reception:	n/a
Integrated container for rescue system:	No		
Volume container [cm ³]:	n/a max n/a min		
Date of reception:	18.10.2022		

Test report summary		Structural test	Impact pad test
Result:	POSITIVE	n/a	n/a
Place:	Villeneuve	n/a	n/a
Date:	18.10.2022	n/a	n/a

Issue data	
Place of declaration:	Villeneuve
Date of issue:	25.10.2022
Managing Director:	Andrea Wigger
Signature:	

This signature approves the validity of the test reports 94.21b and 94.22 (only if test reports are applicable)
Air Turquoise SA, has thoroughly tested the sample mentioned above and certifies its conformity with the following standards:
EN1561:2019+A1:2020⁽²⁾ and EN14891:2019+A1:2021⁽³⁾

⁽¹⁾ If impact pad is NOT integrated in the harness, it will have independently inspection number, and serial number. Definition of integrated impact pad is impact pad which can not be dismounted from the harness, e.g. airbag
⁽²⁾ These standards are NOT covered by accreditation 0-10-19457-01
The certificate of inspection is completed with test reports, if available, number: 94.21b and 94.22
This declaration must not be reproduced in part without the written permission of Air Turquoise SA.

9- TECHNICAL DATA

Carabiner height	47 cm (M) - 50 cm (M) - 52 cm (L)
Distance between carabiners	34,5 cm (M) - 36 cm (M) - 37,5 cm (L)
DENALI 2 Total weight	286 gr (S) - 300 gr (M) - 316 gr (L)
Harness type	Get-Up
Reserve parachute housing	Optional ventral container
Storage volume of reserve parachute	3600 – 5600cm ³
Usage limit	120 daN
Approval number	XXXXXXXXXXXXXXXXXX

Every effort has been made to ensure that the information provided in this manual is accurate, but please note that it is intended solely as a guide. This user manual is subject to change without notice. Check www.woodyvalley.com for the most up-to-date information concerning DENALI 2.

Last update: APRIL 2025